

# S-Series, Square Drive Hydraulic Torque Wrenches

▼ Shown: S3000PX



## Safety and Performance

- Compact, high-strength uni-body construction provides a small operating radius without sacrificing endurance
- 35° rotation angle and rapid return stroke for fast operation
- Tough manifold design with added safety feature for enhanced operator safety

## Simplicity

- 360° click-on reaction arm with quick release lever provides easier handling, even with gloves on
- Includes robust handle which mounts on both sides of tool for extra maneuverability
- Push button square drive release for quickly reversing the square drive for tightening or loosening

## Versatility

- Available with optional enhanced tilt and swivel TSP300 manifold for horizontal and vertical maneuverability, with greater durability <sup>1)</sup>

## Accuracy

- Constant torque output provides accuracy of  $\pm 3\%$  across full stroke
- Optional Angle-of-Turn Indicator provides measurement of rotation.

## Setting New Standards in Safety, Simplicity and Performance

Torque and tension specialist



### Two Handle Styles

Robust angled positioning handle comes standard with every S-Series (X-Edition) tool. Straight positioning handles are available as accessories.

| Compatible S-Series (X-Edition) wrenches | Model Nr. Angled positioning handles (standard) | Model Nr. Straight positioning handles (optional) |
|--|---|---|
| S1500X, S3000X                           | <b>SWH6A</b>                                    | <b>SWH6S</b>                                      |
| S6000X, S11000X                          | <b>SWH10A</b>                                   | <b>SWH10S</b>                                     |
| S25000X                                  | <b>SWH10EA</b> <sup>2)</sup>                    |   |

<sup>2)</sup> SWH10EA is an eyebolt handle.



### TSP - Pro Series Swivel

The optional TSP300 tilt and swivel manifold with robust interlocking design provides 360° X-axis rotation and 160° Y-axis rotation.

### How to Order <sup>1)</sup>

Factory fitted to S-Series (X-Edition) wrenches: Insert a "P" prior to the "X" in the tool model number, example: **S1500PX**.

Order as an accessory using the model number: **TSP300**, which can be fitted to existing S-Series (X-Edition) wrenches. Includes male and female couplers.

Page: 183



### ATEX declared. Calibration certificate included.

All X-edition tools are CE - ATEX declared and are shipped complete with a calibration certificate.

CE Ex II 2 GD T4

<sup>1)</sup> TSP300 is designed for X-Edition tools only, and is not compatible with previous edition tools. For replacement components for existing tools, refer to repair sheet on [www.enerpac.com](http://www.enerpac.com)

# X-Edition, Square Drive Torque Wrenches

Standard are: ① ② ⑥ ⑧  
Other items are optional.

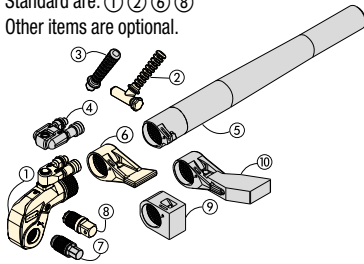

- ① Drive Unit
- ② Angeled Positioning Handle
- ③ Straight Positioning Handle
- ④ Pro Series Swivel
- ⑤ Reaction Tube Extension
- ⑥ Standard Reaction Arm
- ⑦ Allen Drive
- ⑧ Square Drive
- ⑨ Short Reaction Arm
- ⑩ Extended Reaction Arm

**Select the Right Torque**  
Choose your Enerpac Torque Wrench using the untightening rule of thumb:  
Loosening torque equals about 250% of tightening torque.

## S Series X-Edition



Nominal Torque Output:  
**35.455 Nm**

Square Drive Range:  
**3/4 - 2 1/2 inch**

Nose Radius:  
**25 - 64 mm**

Maximum Operating Pressure:  
**690 bar**

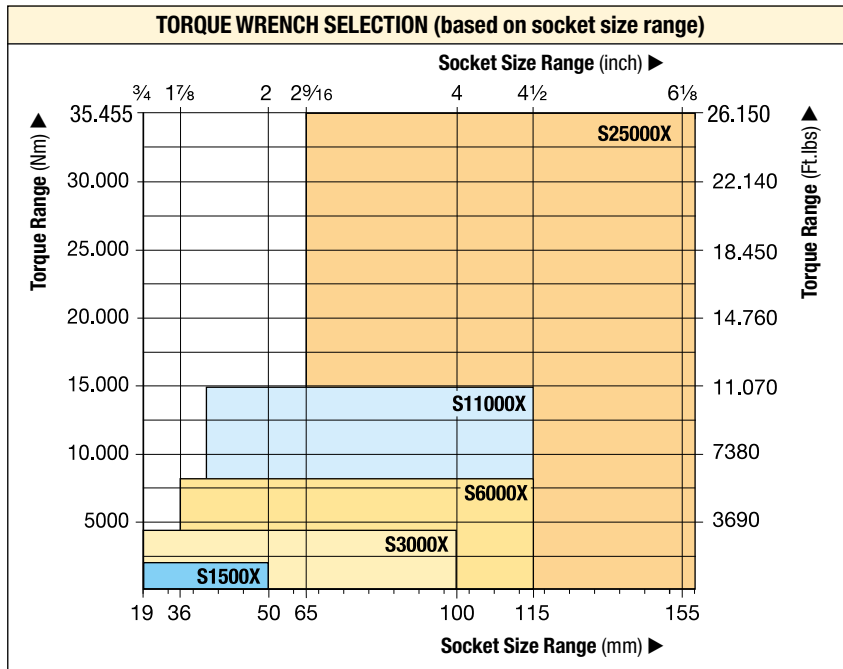

**Use only Heavy Duty Impact Sockets**  
For power driven torquing equipment, according to ISO2725 and ISO1174; DIN 3129 and DIN 3121 or ASME-B107.2/1995.

**Page: 184**

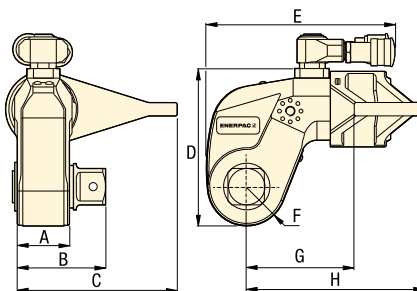

**Accessory Options**  
A full list of optional accessories is available for maximum versatility.

**Page: 183**

▼ The rigid steel design of the S-Series torque wrenches provides durability, reliability and safety.



| Nominal Torque at 690 bar |          | Minimum Torque at 69 bar |          | Square Drive Size (inch) |                                  | Angle-of-Turn Model Nr. (optional) | Torque Wrench Model Number * | Dimensions (mm) |     |     |     |     |    |     |     | Weight (kg) |
|---------------------------|----------|--------------------------|----------|--------------------------|----------------------------------|------------------------------------|------------------------------|-----------------|-----|-----|-----|-----|----|-----|-----|-------------|
| (Nm)                      | (Ft.lbs) | (Nm)                     | (Ft.lbs) |                          | Model Nr. (included with wrench) |                                    |                              | A               | B   | C   | D   | E   | F  | G   | H   |             |
| 1952                      | 1440     | 195                      | 144      | 3/4                      | SD15-012                         | AOT15                              | <b>S1500X</b>                | 39              | 65  | 108 | 97  | 136 | 25 | 70  | 129 | 3,2         |
| 4373                      | 3225     | 438                      | 323      | 1                        | SD30-100                         | AOT30                              | <b>S3000X</b>                | 48              | 78  | 135 | 128 | 173 | 33 | 90  | 161 | 5,6         |
| 8338                      | 6150     | 834                      | 615      | 1 1/2                    | SD60-108                         | AOT60                              | <b>S6000X</b>                | 55              | 92  | 169 | 157 | 192 | 40 | 110 | 188 | 9,2         |
| 15.151                    | 11.175   | 1516                     | 1118     | 1 1/2                    | SD110-108                        | AOT110                             | <b>S11000X</b>               | 72              | 114 | 197 | 190 | 228 | 50 | 133 | 229 | 15,8        |
| 35.455                    | 26.150   | 3545                     | 2615     | 2 1/2                    | SD250-208                        | AOT250                             | <b>S25000X</b>               | 89              | 143 | 246 | 244 | 287 | 64 | 182 | 295 | 32,2        |

\* To order a S-Series (X-edition) torque wrench fitted with a TSP300 tilt and swivel manifold, insert a "P" prior to the "X" in the tool model number, example: **S1500PX**.

Maximum Torque at 690 bar:

**35.455 Nm**

Hexagon Size Allen Drive:

**½ - 2¼ inch**

Hexagon Size Allen Drive:

**14 - 85 mm**

For  
**S**  
Series

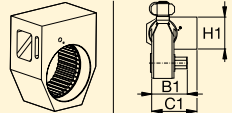

| Torque Wrench<br> | Optional Allen Drives, Imperial      |                        |              |                    | Optional Allen Drives, Metric      |                        |              |                    | Short Reaction Arm for Allen Drives<br> |                               |     |
|---|--------------------------------------|------------------------|--------------|--------------------|------------------------------------|------------------------|--------------|--------------------|--|-------------------------------|-----|
|   | Hexagon Size <sup>1)</sup><br>(inch) | Maximum Torque<br>(Nm) | Model Number | Dim.<br>B1<br>(mm) | Hexagon Size <sup>1)</sup><br>(mm) | Maximum Torque<br>(Nm) | Model Number | Dim.<br>B1<br>(mm) | Model Number   | Dimensions<br>(mm)<br>C1   H1 |     |
| <b>S1500X</b><br>(1952 Nm)  | ½                                    | 481                    | SDA15-008    | 66                 | 14                                 | 644                    | SDA15-14     | 66                 | <b>SRA15X</b>  | 67,5                          | 74  |
|   | 5/8                                  | 936                    | SDA15-010    | 67                 | 17                                 | 1152                   | SDA15-17     | 68                 |  |                               |     |
|   | ¾                                    | 1620                   | SDA15-012    | 71                 | 19                                 | 1607                   | SDA15-19     | 70                 |  |                               |     |
|   | 7/8                                  | 1952                   | SDA15-014    | 74                 | 22                                 | 1952                   | SDA15-22     | 73                 |  |                               |     |
|   | 1                                    | 1952                   | SDA15-100    | 77                 | 24                                 | 1952                   | SDA15-24     | 74                 |  |                               |     |
| <b>S3000X</b><br>(4373 Nm)  | 5/8                                  | 936                    | SDA30-010    | 77                 | 17                                 | 1152                   | SDA30-17     | 77                 | <b>SRA30X</b>  | 80,0                          | 74  |
|   | ¾                                    | 1620                   | SDA30-012    | 80                 | 19                                 | 1607                   | SDA30-19     | 79                 |  |                               |     |
|   | 7/8                                  | 2569                   | SDA30-014    | 83                 | 22                                 | 2488                   | SDA30-22     | 82                 |  |                               |     |
|   | 1                                    | 3830                   | SDA30-100    | 86                 | 24                                 | 3234                   | SDA30-24     | 84                 |  |                               |     |
|   | 1 1/8                                | 4373                   | SDA30-102    | 88                 | 27                                 | 4373                   | SDA30-27     | 85                 |  |                               |     |
|   | 1 1/4                                | 4373                   | SDA30-104    | 89                 | 30                                 | 4373                   | SDA30-30     | 87                 |  |                               |     |
|   | -                                    | -                      | -            | -                  | 32                                 | 4373                   | SDA30-32     | 88                 |  |                               |     |
| <b>S6000X</b><br>(8338 Nm)  | 5/8                                  | 936                    | SDA60-010    | 85                 | 17                                 | 1152                   | SDA60-17     | 86                 | <b>SRA60X</b>  | 91,5                          | 89  |
|   | ¾                                    | 1620                   | SDA60-012    | 89                 | 19                                 | 1607                   | SDA60-19     | 88                 |  |                               |     |
|   | 7/8                                  | 2569                   | SDA60-014    | 92                 | 22                                 | 2488                   | SDA60-22     | 91                 |  |                               |     |
|   | 1                                    | 3830                   | SDA60-100    | 95                 | 24                                 | 3234                   | SDA60-24     | 93                 |  |                               |     |
|   | 1 1/8                                | 5457                   | SDA60-102    | 97                 | 27                                 | 4603                   | SDA60-27     | 94                 |  |                               |     |
|   | 1 1/4                                | 7484                   | SDA60-104    | 98                 | 30                                 | 6311                   | SDA60-30     | 96                 |  |                               |     |
|   | -                                    | -                      | -            | -                  | 32                                 | 7660                   | SDA60-32     | 97                 |  |                               |     |
| <b>S11000X</b><br>(15.151 Nm)   | 1 1/4                                | 7484                   | SDA110-104   | 115                | 30                                 | 6311                   | SDA110-30    | 112                | <b>SRA110X</b>   | 127,5                         | 106 |
|   | 1 3/8                                | 9958                   | SDA110-106   | 117                | 32                                 | 7660                   | SDA110-32    | 114                |  |                               |     |
|   | 1 1/2                                | 12.928                 | SDA110-108   | 118                | 36                                 | 10.901                 | SDA110-36    | 117                |  |                               |     |
|   | 1 5/8                                | 15.151                 | SDA110-110   | 122                | 41                                 | 15.151                 | SDA110-41    | 121                |  |                               |     |
|   | 1 3/4                                | 15.151                 | SDA110-112   | 125                | 46                                 | 15.151                 | SDA110-46    | 127                |  |                               |     |
| <b>S25000X</b><br>(35.455 Nm)   | 1 1/2                                | 12.928                 | SDA250-108   | 141                | 36                                 | 10.901                 | SDA250-36    | 140                | <b>SRA250X</b>   | 158,5                         | 135 |
|   | 1 5/8                                | 16.433                 | SDA250-110   | 145                | 41                                 | 16.107                 | SDA250-41    | 144                |  |                               |     |
|   | 1 3/4                                | 20.520                 | SDA250-112   | 148                | 46                                 | 22.744                 | SDA250-46    | 148                |  |                               |     |
|   | 1 7/8                                | 25.245                 | SDA250-114   | 149                | 50                                 | 29.211                 | SDA250-50    | 151                |  |                               |     |
|   | 2                                    | 30.635                 | SDA250-200   | 151                | 55                                 | 35.455                 | SDA250-55    | 154                |  |                               |     |
|   | 2 1/4                                | 35.455                 | SDA250-204   | 154                | 60                                 | 35.455                 | SDA250-60    | 158                |  |                               |     |
|   | -                                    | -                      | -            | -                  | 65                                 | 35.455                 | SDA250-65    | 161                |  |                               |     |
|   | -                                    | -                      | -            | -                  | 70                                 | 35.455                 | SDA250-70    | 164                |  |                               |     |
|   | -                                    | -                      | -            | -                  | 75                                 | 35.455                 | SDA250-75    | 168                |  |                               |     |
|   | -                                    | -                      | -            | -                  | 85                                 | 35.455                 | SDA250-85    | 175                |  |                               |     |

<sup>1)</sup> See page 271 for table of hexagon sizes of bolts, nuts and related thread diameters.

# Accessories for S-Series, X-Edition Wrenches

## TSP RTEX SRSX Series



### TSP-Series, Pro Series Swivel

- Robust interlocking design
- 360° X-axis and 160° Y-axis rotation
- Increases tool fit in restricted access areas
- Simplifies hose placement
- Includes male and female couplers

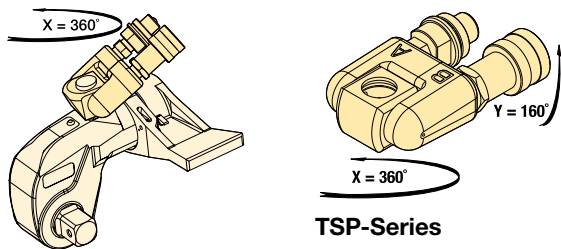

TSP-Series

| For Torque Wrench Model Number           | Model Number <sup>1)</sup> | Maximum Pressure (bar) | Weight (kg) |
|--|----------------------------|------------------------|-------------|
| S1500X, S3000X, S6000X, S11000X, S25000X | TSP300                     | 690                    | 0,2         |

<sup>1)</sup> To order a S-Series (X-edition) torque wrench fitted with a TSP300 tilt and swivel manifold, insert a "P" prior to the "X" in the tool model number, example: **S1500PX**. TSP300 is designed for X-Edition tools only, and is not compatible with standard edition tools. For replacement components for existing tools, refer to repair sheet on [www.enerpac.com](http://www.enerpac.com)

### RTEX-Series, Reaction Tube Extensions

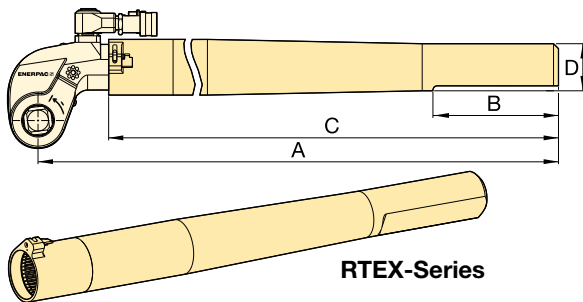

RTEX-Series

- Full torque rated
- Increases tool fit in restricted access areas

| For Torque Wrench Model Number | Model Number | Dimensions (mm) |     |     |     | Weight (kg) * |
|--------------------------------|--------------|-----------------|-----|-----|-----|---------------|
|                                |              | A               | B   | C   | D   |               |
| S1500X                         | RTE15X       | 706             | 152 | 636 | 58  | 4,6           |
| S3000X                         | RTE30X       | 733             | 152 | 647 | 57  | 5,5           |
| S6000X                         | RTE60X       | 747             | 152 | 659 | 65  | 7,7           |
| S11000X                        | RTE110X      | 769             | 152 | 675 | 76  | 11,2          |
| S25000X                        | RTE250X      | 813             | 152 | 685 | 100 | 17,3          |

\* Weights indicated are for the accessories only and do not include the wrench.

### SRSX-Series, Extended Reaction Arms

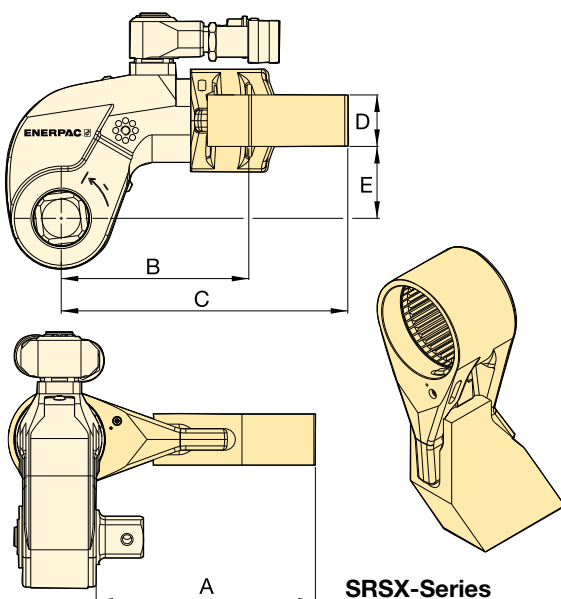

SRSX-Series

- Lightweight interchangeable design

| For Wrench Model | Max. Torque (Nm) | Model Number | Dimensions (mm) |     |     |    |     | Weight (kg) * |
|------------------|------------------|--------------|-----------------|-----|-----|----|-----|---------------|
|                  |                  |              | A               | B   | C   | D  | E   |               |
| S1500X           | 1801             | SRS151X      | 94              | 86  | 127 | 24 | 34  | 0,8           |
|                  | 1641             | SRS152X      | 119             | 97  | 138 | 24 | 34  | 1,0           |
|                  | 1533             | SRS153X      | 145             | 109 | 148 | 24 | 34  | 1,2           |
| S3000X           | 3918             | SRS301X      | 111             | 106 | 168 | 34 | 48  | 1,6           |
|                  | 3712             | SRS302X      | 137             | 117 | 182 | 34 | 48  | 2,0           |
|                  | 3574             | SRS303X      | 162             | 132 | 198 | 34 | 48  | 2,5           |
| S6000X           | 7842             | SRS601X      | 138             | 128 | 192 | 39 | 62  | 2,3           |
|                  | 7454             | SRS602X      | 163             | 144 | 207 | 39 | 62  | 2,7           |
|                  | 7175             | SRS603X      | 189             | 159 | 222 | 39 | 62  | 3,4           |
| S11000X          | 14.650           | SRS1101X     | 149             | 157 | 232 | 46 | 76  | 4,4           |
|                  | 13.957           | SRS1102X     | 175             | 172 | 247 | 46 | 76  | 5,1           |
|                  | 13.391           | SRS1103X     | 200             | 187 | 261 | 46 | 76  | 5,8           |
| S25000X          | 33.538           | SRS2501X     | 183             | 209 | 295 | 50 | 100 | 7,6           |
|                  | 32.049           | SRS2502X     | 208             | 222 | 310 | 50 | 100 | 8,4           |
|                  | 30.750           | SRS2503X     | 233             | 236 | 326 | 50 | 100 | 10,0          |

\* Weights indicated are for the accessories only and do not include the wrench.

# BSH-Series, Heavy-Duty Sockets

- Heavy-duty impact sockets
- Supplied with "Pin and Ring"

## METRIC SOCKETS

| ¾" Square Drive |          | 1" Square Drive |          | 1½" Square Drive |          | 2½" Square Drive |          |
|-----------------|----------|-----------------|----------|------------------|----------|------------------|----------|
| Model Number    | A/F (mm) | Model Number    | A/F (mm) | Model Number     | A/F (mm) | Model Number     | A/F (mm) |
| BSH7519         | 19       | BSH1019         | 19       | BSH1536          | 36       | BSH2565          | 65       |
| BSH7524         | 24       | BSH1024         | 24       | BSH15163         | 41       | BSH2570          | 70       |
| BSH7527         | 27       | BSH1027         | 27       | BSH1546          | 46       | BSH2575          | 75       |
| BSH7530         | 30       | BSH1030         | 30       | BSH1550          | 50       | BSH2580          | 80       |
| BSH7532         | 32       | BSH1032         | 32       | BSH1555          | 55       | BSH2585          | 85       |
| BSH7536         | 36       | BSH1036         | 36       | BSH1560          | 60       | BSH2590          | 90       |
| BSH75163        | 41       | BSH10163        | 41       | BSH1565          | 65       | BSH2595          | 95       |
| BSH7546         | 46       | BSH1046         | 46       | BSH1570          | 70       | BSH25100         | 100      |
| BSH7550         | 50       | BSH1050         | 50       | BSH1575          | 75       | BSH25105         | 105      |
| -               | -        | BSH1055         | 55       | BSH1580          | 80       | BSH25110         | 110      |
| -               | -        | BSH1060         | 60       | BSH1585          | 85       | BSH25115         | 115      |
| -               | -        | BSH1065         | 65       | BSH1590          | 90       | BSH25120         | 120      |
| -               | -        | BSH1070         | 70       | BSH1595          | 95       | BSH25125         | 125      |
| -               | -        | BSH1075         | 75       | BSH15100         | 100      | BSH25135         | 135      |
| -               | -        | BSH1080         | 80       | BSH15105         | 105      | BSH25140         | 140      |
| -               | -        | BSH1085         | 85       | BSH15110         | 110      | BSH25145         | 145      |
| -               | -        | BSH1090         | 90       | BSH15115         | 115      | BSH25150         | 150      |
| -               | -        | BSH1095         | 95       | -                | -        | BSH25155         | 155      |
| -               | -        | BSH10100        | 100      | -                | -        | -                | -        |

## BSH Series



Hexagon Size:

**19 - 155 mm | ¾" - 6 1/8"**



### Select the Right Torque

Choose your Enerpac Torque Wrench using the untightening rule of thumb: Loosening torque equals about 250% of tightening torque.

Page: 272

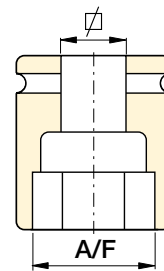

### Hexagon Bolt and Nut Sizes

See the table of hexagon sizes of bolts, nuts and related thread diameters.

Page: 271

## IMPERIAL SOCKETS

| ¾" Square Drive |            | 1" Square Drive |            |              |            | 1½" Square Drive |            |              |            | 2½" Square Drive |            |              |            |
|-----------------|------------|-----------------|------------|--------------|------------|------------------|------------|--------------|------------|------------------|------------|--------------|------------|
| Model Number    | A/F (inch) | Model Number    | A/F (inch) | Model Number | A/F (inch) | Model Number     | A/F (inch) | Model Number | A/F (inch) | Model Number     | A/F (inch) | Model Number | A/F (inch) |
| BSH7519         | ¾"         | BSH1019         | ¾"         | BSH10231     | 2 5/16"    | BSH15144         | 1 7/16"    | BSH15281     | 2 13/16"   | BSH25244         | 2 7/16"    | BSH25419     | 4 3/16"    |
| BSH75088        | 7/8"       | BSH10088        | 7/8"       | BSH10238     | 2 3/8"     | BSH1538          | 1 1/2"     | BSH15288     | 2 7/8"     | BSH25250         | 2 1/2"     | BSH25425     | 4 1/4"     |
| BSH75094        | 15/16"     | BSH10094        | 15/16"     | BSH10244     | 2 7/16"    | BSH15156         | 1 9/16"    | BSH1575      | 2 15/16"   | BSH2565          | 2 13/16"   | BSH25110     | 4 5/16"    |
| BSH7527         | 1 1/16"    | BSH1027         | 1 1/16"    | BSH10250     | 2 1/2"     | BSH15163         | 1 5/8"     | BSH15300     | 3"         | BSH25263         | 2 5/8"     | BSH25438     | 4 3/8"     |
| BSH7530         | 1 3/16"    | BSH1030         | 1 3/16"    | BSH1065      | 2 9/16"    | BSH1543          | 1 11/16"   | BSH15306     | 3 1/16"    | BSH25269         | 2 11/16"   | BSH25450     | 4 1/2"     |
| BSH75125        | 1 ¼"       | BSH10125        | 1 ¼"       | BSH10263     | 2 5/8"     | BSH15175         | 1 ¾"       | BSH15313     | 3 1/8"     | BSH2570          | 2 ¾"       | BSH25463     | 4 5/8"     |
| BSH75131        | 1 5/16"    | BSH10131        | 1 5/16"    | BSH10269     | 2 11/16"   | BSH1546          | 1 13/16"   | BSH15319     | 3 3/16"    | BSH25281         | 2 11/16"   | BSH25475     | 4 ¾"       |
| BSH7535         | 1 3/8"     | BSH1035         | 1 3/8"     | BSH1070      | 2 ¾"       | BSH15188         | 1 7/8"     | BSH15325     | 3 ¼"       | BSH25288         | 2 7/8"     | BSH25488     | 4 7/8"     |
| BSH75144        | 1 7/16"    | BSH10144        | 1 7/16"    | BSH10281     | 2 13/16"   | BSH15194         | 1 15/16"   | BSH15338     | 3 3/8"     | BSH2575          | 2 15/16"   | BSH25500     | 5"         |
| BSH7538         | 1 ½"       | BSH1038         | 1 ½"       | BSH10288     | 2 7/8"     | BSH15200         | 2"         | BSH15350     | 3 1/2"     | BSH25300         | 3"         | BSH25513     | 5 1/8"     |
| BSH75156        | 1 9/16"    | BSH10156        | 1 9/16"    | BSH1075      | 2 15/16"   | BSH15206         | 2 1/16"    | BSH15363     | 3 5/8"     | BSH25306         | 3 1/16"    | BSH25519     | 5 3/16"    |
| BSH75163        | 1 5/8"     | BSH10163        | 1 5/8"     | BSH10300     | 3"         | BSH15213         | 2 1/8"     | BSH1595      | 3 ¾"       | BSH25313         | 3 1/8"     | BSH25525     | 5 1/4"     |
| BSH7543         | 1 11/16"   | BSH1043         | 1 11/16"   | BSH10306     | 3 1/16"    | BSH15219         | 2 3/16"    | BSH15388     | 3 7/8"     | BSH25319         | 3 3/16"    | BSH25538     | 5 3/8"     |
| BSH75175        | 1 ¾"       | BSH10175        | 1 ¾"       | BSH10313     | 3 1/8"     | BSH15225         | 2 ¼"       | BSH15100     | 3 15/16"   | BSH25325         | 3 ¼"       | BSH25140     | 5 1/2"     |
| BSH7546         | 1 13/16"   | BSH1046         | 1 13/16"   | BSH10319     | 3 3/16"    | BSH15231         | 2 5/16"    | BSH15400     | 4"         | BSH25338         | 3 3/8"     | BSH25575     | 5 ¾"       |
| BSH75188        | 1 7/8"     | BSH10188        | 1 7/8"     | BSH10325     | 3 ¼"       | BSH15238         | 2 3/8"     | BSH15105     | 4 1/8"     | BSH25350         | 3 1/2"     | BSH25150     | 5 7/8"     |
| BSH75194        | 1 15/16"   | BSH10194        | 1 15/16"   | BSH10338     | 3 3/8"     | BSH15244         | 2 7/16"    | BSH15419     | 4 3/16"    | BSH25363         | 3 5/8"     | BSH25600     | 6"         |
| BSH75200        | 2"         | BSH10200        | 2"         | BSH10350     | 3 1/2"     | BSH15250         | 2 1/2"     | BSH15425     | 4 ¼"       | BSH2595          | 3 ¾"       | BSH25613     | 6 1/8"     |
| -               | -          | BSH10206        | 2 1/16"    | BSH10363     | 3 5/8"     | BSH1565          | 2 9/16"    | BSH15110     | 4 5/16"    | BSH25388         | 3 7/8"     | -            | -          |
| -               | -          | BSH10213        | 2 1/8"     | BSH1095      | 3 ¾"       | BSH15263         | 2 5/8"     | BSH15438     | 4 3/8"     | BSH25100         | 3 15/16"   | -            | -          |
| -               | -          | BSH10219        | 2 3/16"    | BSH10388     | 3 7/8"     | BSH15269         | 2 11/16"   | BSH15450     | 4 1/2"     | BSH25400         | 4"         | -            | -          |
| -               | -          | BSH10225        | 2 ¼"       | -            | -          | BSH1570          | 2 ¾"       | BSH15463     | 4 5/8"     | BSH25105         | 4 1/8"     | -            | -          |

Enerpac professional series steel torque wrenches provide reliable controlled tightening solutions across the industry.

### ***S3000X Square Drive Torque Wrench on wind tower erection and maintenance***

*S3000X used to connect wind tower segments during assembly and maintenance. A robust but compact solution is required for tightening of bolts on wind tower sections. Large numbers of fasteners require precise application of torque to ensure joint integrity is achieved and maintained. The Enerpac S-Series wrench was selected as it offers simple and reliable operation while providing accurate and repeatable results.*



### ***W4000X Low Profile Torque Wrench on an API Pipe Flange***

*Throughout the Oil and Gas, Petrochemical and Processing Industries, pipeline joints, valves, pumps and machinery present challenges for controlled bolting. The restricted access on this flange was easily overcome with an Enerpac W-Series Torque Wrench. These wrenches offer reliability and control, ensuring even and consistent torque is applied to all bolts.*

### ***S3000X on an oil and gas flange***

*During maintenance quick turnaround times are essential; S-Series wrenches are chosen as they provide a large angle of nut rotation per stroke, offering speed and accuracy in a compact ergonomic tool.*

